

12ft High Security Offices & Canteens

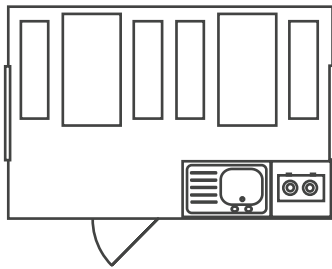

- ✎ High Security Steel Shutters & Doors*
- ✎ Gas or Electric Heating/Lighting/Cooking*
- ✎ Optional Electric/Gaandwash facilities*
- ✎ Supplied c/w furniture*
- ✎ Ideal for sites with limited space*

12'x8' Canteen



Electric or LPG gas

12'x8' Office

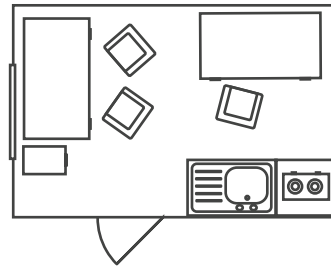

Electric or LPG gas

12'x8' Office / Canteen

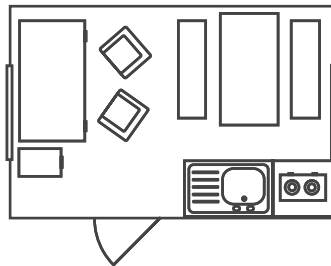

Electric or LPG gas

12'x8' Drying Room

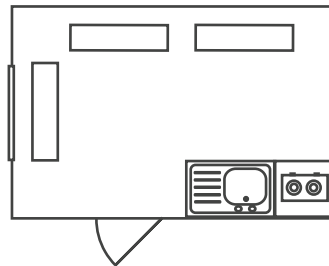

Electric or LPG gas

High Security Mobile Offices & Canteens



- ✎ Ideal for sites with limited access*
- ✎ Gas or Electric Heating/Lighting/Cooking*
- ✎ High Security Steel Shutters & Doors*
- ✎ Supplied c/w furniture*
- ✎ 4x4 Storage area*

12'x8' Mobile Canteen / Store

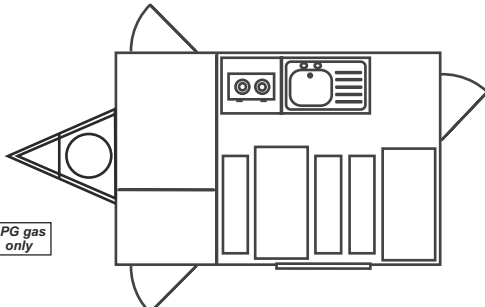

LPG gas only

12'x8' Mobile Office / Store

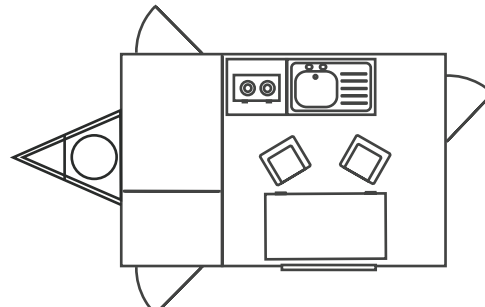

LPG gas only